



## LATERAL ARM AWNINGS

### / PRODUCT CARE AND USE

Please follow these product care instructions. Our aim is to provide you with years of hassle-free weather protection with very little maintenance. Failure to follow these will void your warranty.



**MAKING  
SHADE**

## GENERAL GUIDELINES

Retractable awnings should be used under supervision only as weather conditions can change quickly.

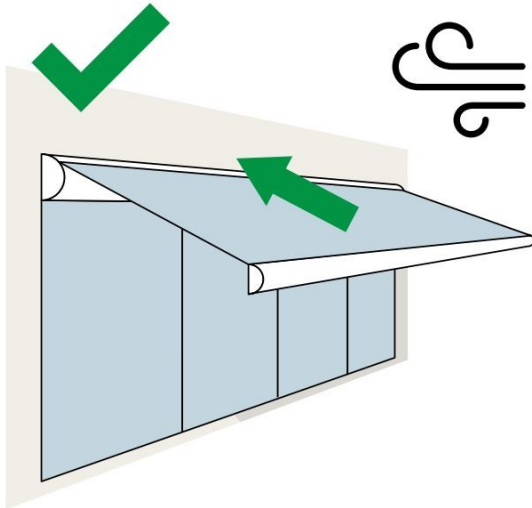

Retractable Awnings should not be out in high winds. Retract when winds get high and in heavy rain. They can withstand small amounts of rain as they have a pitch to them. There is risk of pooling which can stretch the fabric if left out in rain.

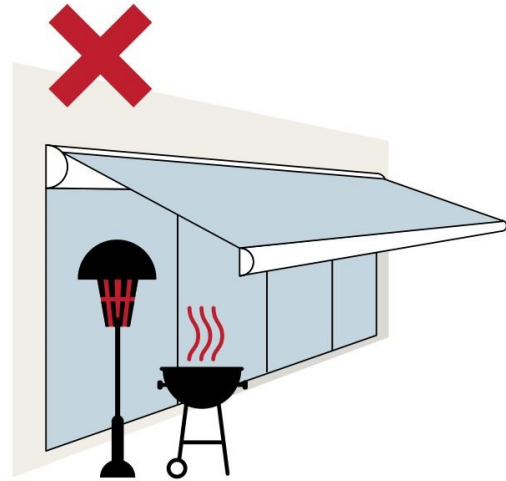

Do not cook beneath your awning. This can damage the fabric and cause mould/mildew.

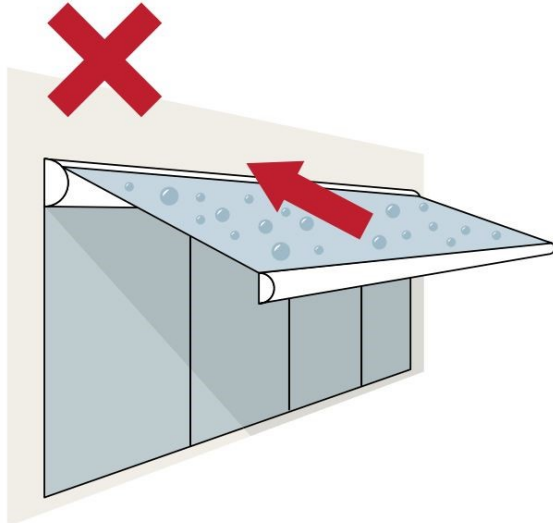

Ensure your awning is dry when rolling away.

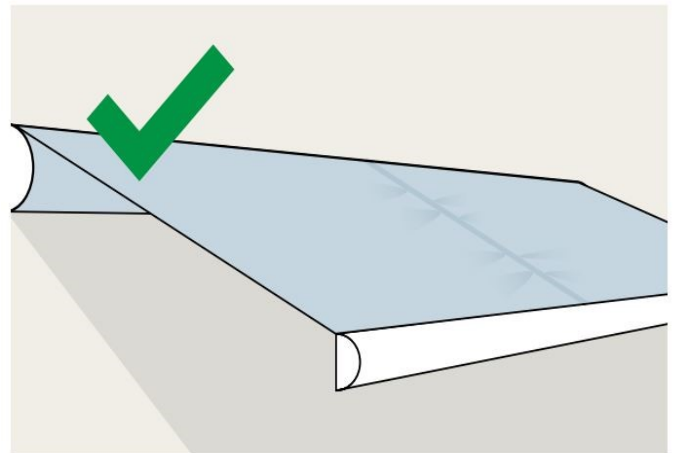

Fabric can have wrinkles or have a slightly wavy effect. This is not a fault and is due to a seam along the width of the fabric.

SHADE SAILS / LOUVRE SHADE  
ZIPTRAK® BLINDS / RETRACTABLE AWNINGS

36f MacDonald Street / Mount Maunganui / 3116  
07 572 5509 / [info@makingshade.co.nz](mailto:info@makingshade.co.nz)  
[WWW.MAKINGSHADE.CO.NZ](http://WWW.MAKINGSHADE.CO.NZ)



MAKING  
SHADE

Creating outdoor living spaces

## OPERATION

### Manual crank-operated awnings

When using the crank handle, turn it slowly and do not try and force it, you must ensure to keep the handle on the same angle as the gearbox position. Wind the awning out until the folding arms are in place and the fabric is at it's most taut position. You may need to wind back slightly to reach this position.

Do not leave the handle outside as this will result in rusting and can bang causing noise and damage.

### Automated awnings

Because inner and outer limits are set at installation, they are very easy to use. Simply push the button (up/down\_ to extend or retract your awning. You can stop the awning at any position by pushing the centre button.

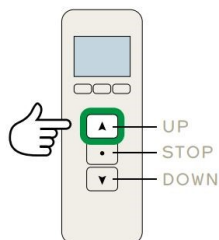

**IMPORTANT NOTE: 'UP' must always be used to return the awning to its retracted position.**

Remotes and sensors are battery operated which will require changing from time to time.

If the awning is fitted with a motion sensor this will send a signal to the motor several times an hour to let the motor know it's still protecting the awning. If the motor does not received the signal for a period of one hour after being opened, it will close automatically as a protective measure. This is also a sign the sensor batteries need replacing.

## Fabric Maintenance

We recommend cleaning your fabric with a soft-bristled brush and rinsing with water. For localised stains, clean with a neutral detergent mixed in luke warm water and rinse.

It is very important to allow fabric to dry completely before rolling it away. The fabric does dry quickly due to its technical characteristics.

### Thermal Protection—Automated products only

If your Retractable awning is automated the motor has a 3-4 minute run time. After this, the motor will stop any operation so it can cool down and won't thermal overload. Allow 30 minutes for this to happen before operating the awning again.

## HARDWARE MAINTENANCE

Our Awning components are powder coated using Dulux powder coat systems. As a general rule cleaning should take place every six months. In areas where pollutants are more prevalent, such as beach front and industrial or geothermal areas, then a cleaning program should be carried out more frequently ie; one to three months.

We recommend cleaning your fabric with a soft bristled brush and rinsing with water. For localised stains, clean with a neutral detergent mixed in lukewarm water and rinse.

Always ensure the fabric is dry completely before rolling it.

## WARRANTY

Your awning comes with a five-year limited warranty on all hardware components of the system. The warranty will be void if the fabrication and/or installation has not been completed according to the manufacturer's specifications or the following:

- Maintenance plan is not followed
- Damage caused by extreme weather events
- Water ingress to the motor (caused by insufficient flashing)
- Vandalism
- Incorrect operation or cleaning